

6030-2Z Deep groove ball bearings

- Popular item

Deep groove ball bearings

Bearing data

[Tolerances](#),

Normal (metric), P6, P5, Normal (inch),

[Radial internal clearance](#),

Matched bearing pairs, Stainless steel
 $d < 10$ mm, Other bearings

Bearing interfaces

[Seat tolerances for standard conditions](#),

[Tolerances and resultant fits](#)

Technical specification

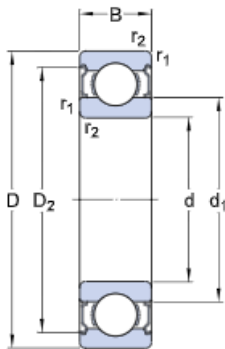

DIMENSIONS

d	150 mm	Bore diameter
D	225 mm	Outside diameter
B	35 mm	Width
d_1	≈ 174.15 mm	Shoulder diameter
D_2	≈ 205.3 mm	Recess diameter
$r_{1,2}$	min. 2.1 mm	Chamfer dimension

ABUTMENT DIMENSIONS

d_{ξ} min.	160 mm	Diameter of shaft abutment
d_{ξ} max.	173.9 mm	Diameter of shaft abutment
D_{ξ} max.	215 mm	Diameter of housing abutment
r_a max.	2 mm	Radius of shaft or housing fillet

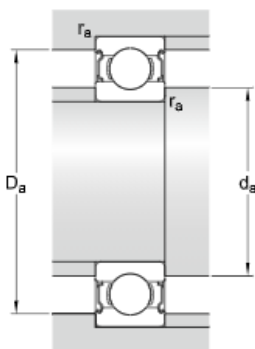

CALCULATION DATA

C	125 kN	Basic dynamic load rating
C ₀	125 kN	Basic static load rating
P _u	3.9 kN	Fatigue load limit
	6 000 r/min	Reference speed
	3 000 r/min	Limiting speed
k _r	0.025	Minimum load factor
f ₀	15.9	Calculation factor

MASS

	4.38 kg	Mass bearing
--	---------	--------------

TOLERANCE CLASS

Normal	Dimensional tolerances
Normal	Radial run-out